

Combination pumps

Type KKP

LP: 160 bar / 0,35 to 4,60 cm³/rev
HP: 700 bar / 0,12 to 1,88 cm³/rev

Features

- Compact and light design
- Can be started at maximum pressure
- Self-priming
- Modular design



Design

- Integrated low-pressure unloading valve
- Integrated fail safe valve (not suitable for continuous operation, must not be used to restrict the system pressure!)
- With hollow shaft for direct mounting of motor without bell housing and coupling

Applications

- For applications that require high flow rates in the low pressure (LP) area and low flow rates in the high pressure (HP) area
- Presses
- Power units for industrial applications such as punching machines and rescue devices

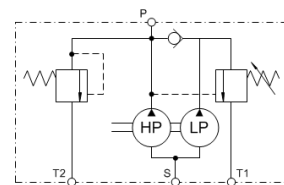

Technical Data

Hydraulic fluid	Mineral oil according to DIN 51524 (other fluids on request)
Fluid temperature range	-20 up to 80 °C
Ambient temperature range	-30 up to 50 °C
Viscosity range	12 to 220 mm ² /s
Operation pressure at suction port	-0,2 bar to 0,5 bar (relative)
Max. operating pressure HP	700 bar
Max. operating pressure LP	60 bar resp. 160 bar (preset by producer)
Filtration (recommendation)	According to NAS 1638 class 6 resp. ISO/DIN 4406 17/15/12
Weight	See product information
Installation position	In oil reservoir (any)
Max. speed range	See Product information
Direction of rotation (position in tank)	Any
Suction height	Max. 150 bzw. 400 mm (see mounting, page 2)
Material	Eccentric shaft and valve block: steel Pump housing and gear pump: aluminium

Type KKP

LP: 160 bar/0,35 to 4,60 cm³/rev
HP: 700 bar/0,12 to 1,88 cm³/rev

Ordering code

Example	KKP	01	-	0,12	-	700	-	0,35	-	60	V	-			00	
Combination pumps																Special design 01 ... 99 (00 for Standard)
Size	01															Part index Please leave it blank (small letters a-z; different letters do not effect interchangeability)
	02															
	03															
	04															
	05															
Displacement HP [cm³/rev]	see product inform.															
Max. operating pressure HP [bar]	see product information															
Displacement LP [cm³/rev]	see product information															
Max. operating pressure LP [bar]	see product information															
Seal material	V [FPM] other seal materials on request															

Type KKP

LP: 160 bar/0,35 to 4,60 cm³/rev
HP: 700 bar/0,12 to 1,88 cm³/rev

Mounting

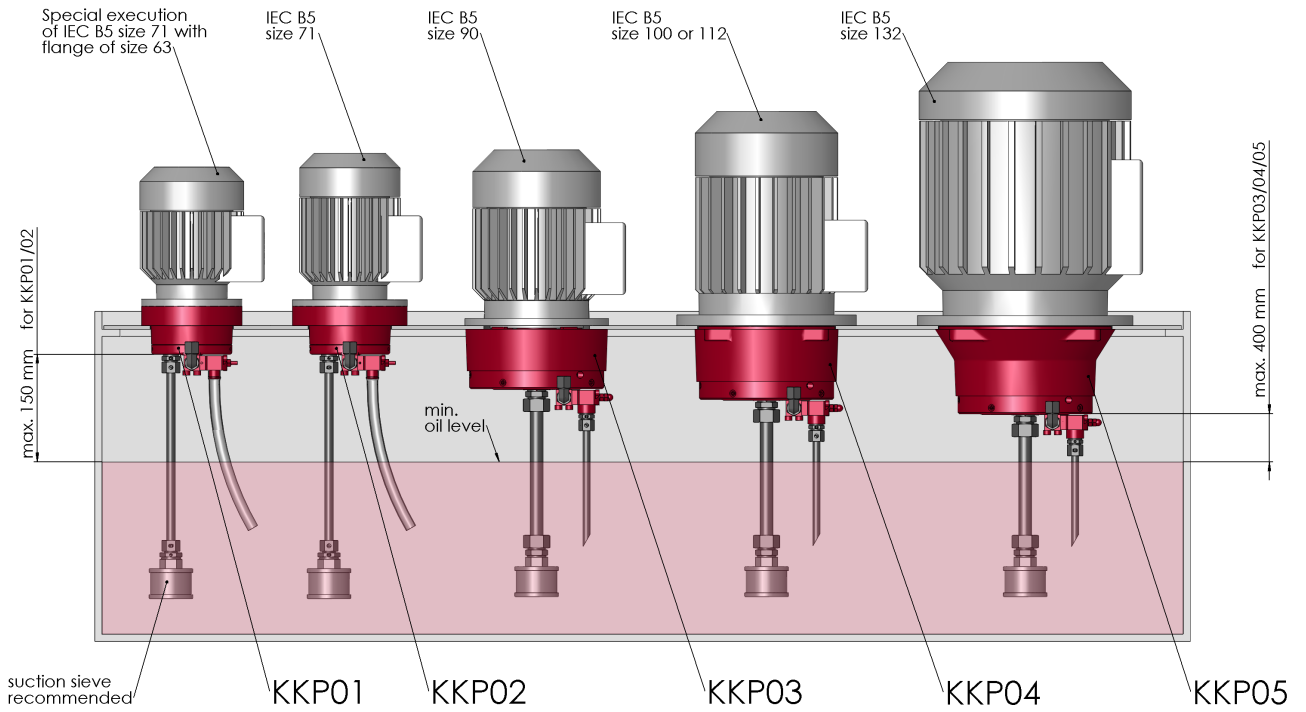

Type KKP

LP: 160 bar/0,35 to 4,60 cm³/rev
 HP: 700 bar/0,12 to 1,88 cm³/rev

Product information

Size	HP mode			LP mode			Speed max. [rpm]	Weight ca.[kg]	Part No.
	Displacement [cm ³ /rev]	Operating pressure max. [bar]	Number of pumping element	Displacement (HP + LP) [cm ³ /rev]	Unloading pressure max. [bar]	Number of pumping element			
01	0,24	700	2	2,08	60	2	3600	1,9	4002107
01	0,24	700	2	2,65	60	2	3600*	1,9	4002101
02	0,17	700	1	1,11	60	2	3600	2,0	4002108
02	0,17	700	1	2,02	60	2	3600	2,0	4002109
02	0,24	700	2	1,18	60	2	3600	2,0	4002110
02	0,24	700	2	2,08	60	2	3600	2,0	4002111
02	0,24	700	2	2,65	60	2	3600*	2,0	4002112
02	0,34	700	2	2,75	60	2	3600*	2,0	3944926
03	0,47	700	3	0,94	160	3	2000	7,9	4002154
03	0,47	700	3	1,15	160	3	2000	7,9	4002155
03	0,47	700	3	1,68	160	3	2000	7,9	4002156
03	0,47	700	3	2,00	160	3	2000	7,9	4002157
03	0,47	700	3	2,36	160	3	2000	7,9	4002158
03	0,47	700	3	3,19	160	3	2000	7,9	4002159
03	0,68	700	3	1,36	160	3	2000	7,9	4002160
03	0,68	700	3	1,88	160	3	2000	7,9	4002161
03	0,68	700	3	2,21	160	3	2000	7,9	4002162
03	0,68	700	3	2,56	160	3	2000	7,9	4002163
04	0,68	700	3	3,39	160	3	2000	8,4	3961199
04	1,21	700	3	2,41	160	3	2000	8,4	4002164
04	1,21	700	3	2,73	160	3	2000	8,4	4002165
04	1,21	700	3	3,09	160	3	2000	8,4	4002166
04	1,21	700	3	3,92	160	3	2000	8,4	4002167
04	1,53	700	3	3,05	160	3	2000	8,4	4002168
04	1,53	700	3	3,41	160	3	2000	8,4	4002169
04	1,53	700	3	4,24	160	3	2000	8,4	4002170
04	1,88	700	3	3,77	160	3	2000	8,4	4002171
04	1,88	700	3	4,60	160	3	2000	8,4	4002172
05	2,71	625	3	5,43	160	3	2000	8,4	4002173

* Due to technical reasons it may occur that the displacement in the low pressure operating range of the marked pumps may not reach the maximum.

Driving motor power and torque: KKP 01 und 02

KKP...-0,17-700-1,11-60

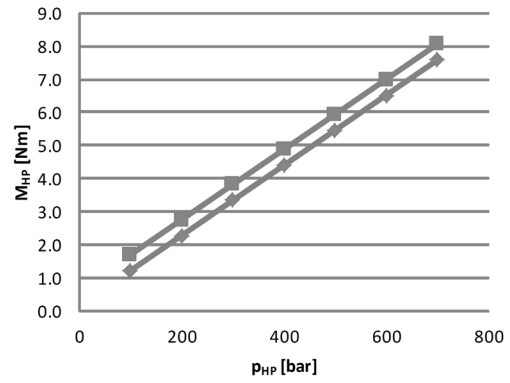
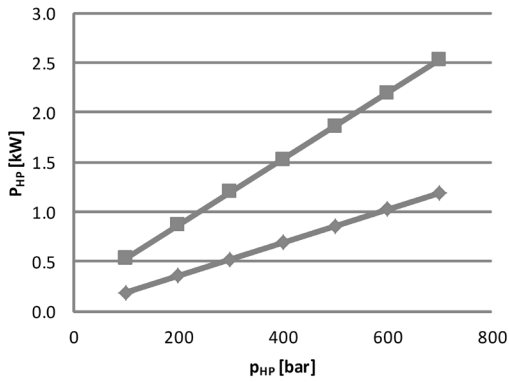

KKP...-0,17-700-2,02-60

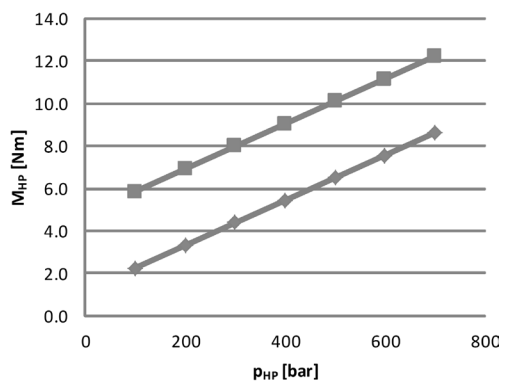
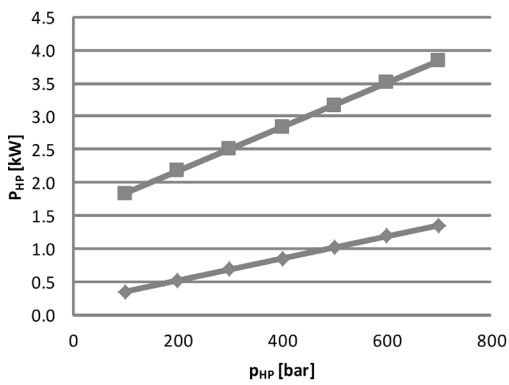

KKP...-0,24-700-0,57-60

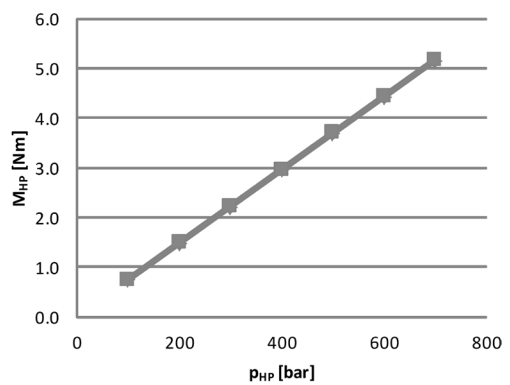
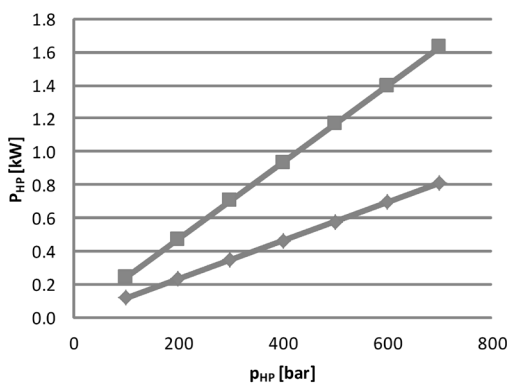

Type KKP

LP: 160 bar/0,35 to 4,60 cm³/rev
 HP: 700 bar/0,12 to 1,88 cm³/rev

KKP...-0,24-700-1,18-60

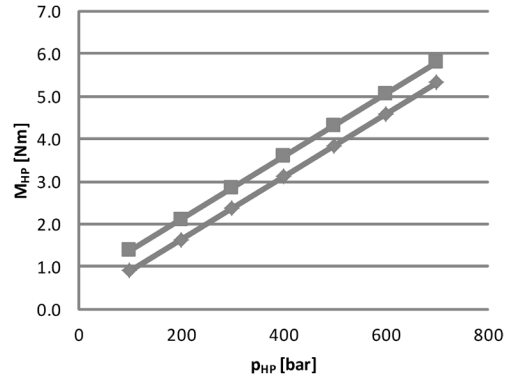
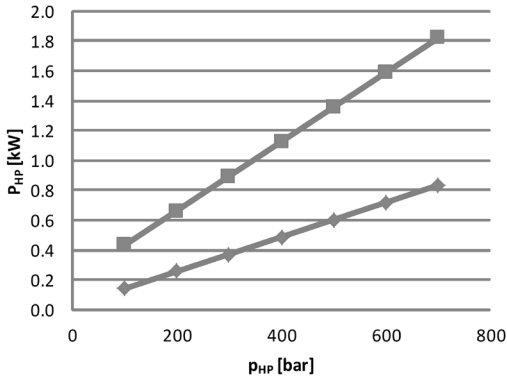

KKP...-0,24-700-2,08-60

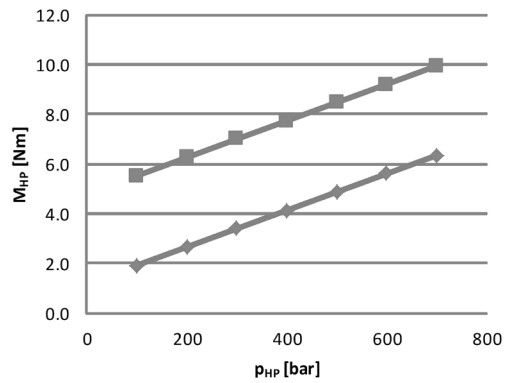
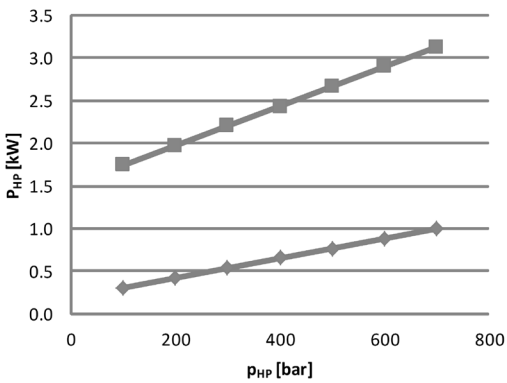

KKP...-0,24-700-2,65-60

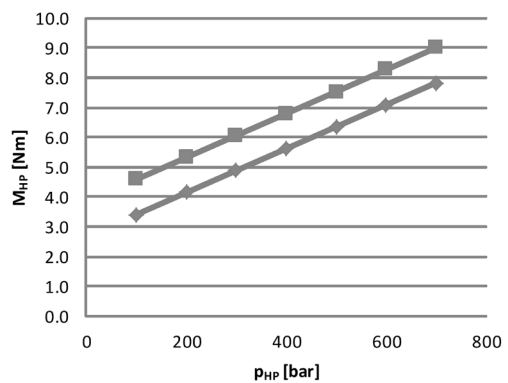
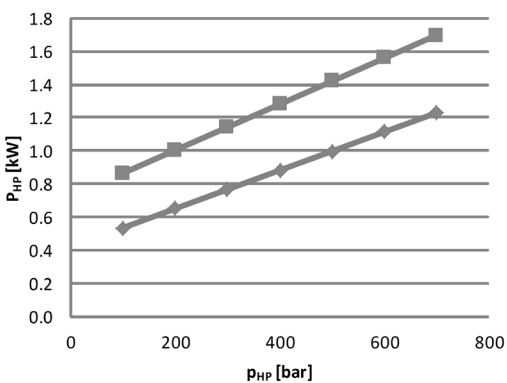

Type KKP

LP: 160 bar/0,35 to 4,60 cm³/rev
HP: 700 bar/0,12 to 1,88 cm³/rev

KKP...-0,34-700-2,75-60

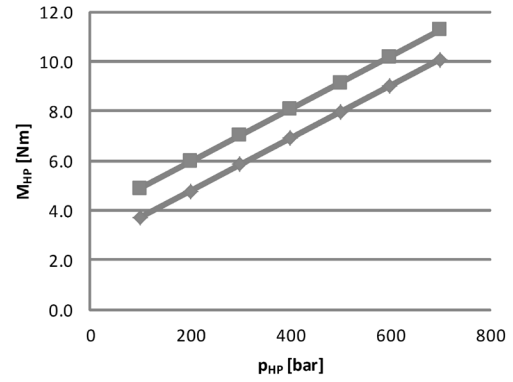
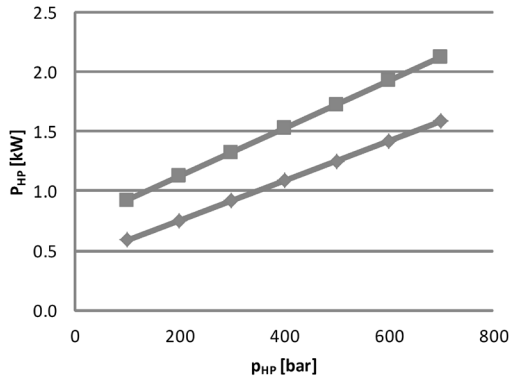

Type KKP

LP: 160 bar/0,35 to 4,60 cm³/rev
 HP: 700 bar/0,12 to 1,88 cm³/rev

Driving motor power and torque: KKP 03, 04 und 05

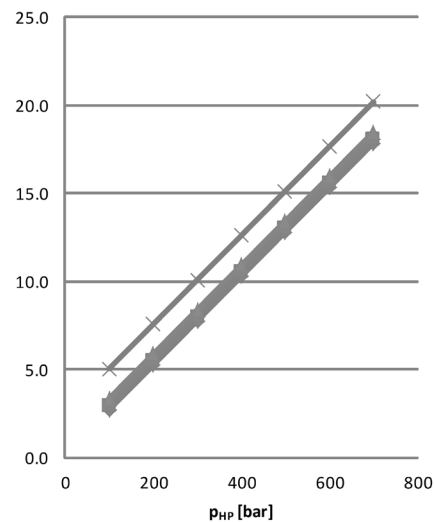
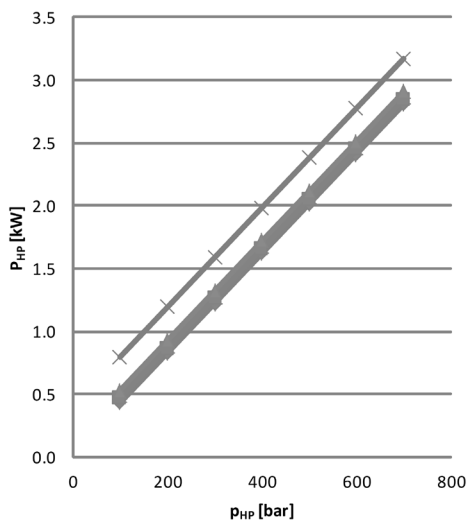
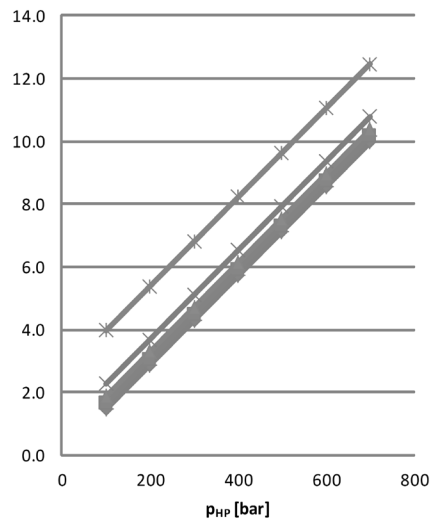
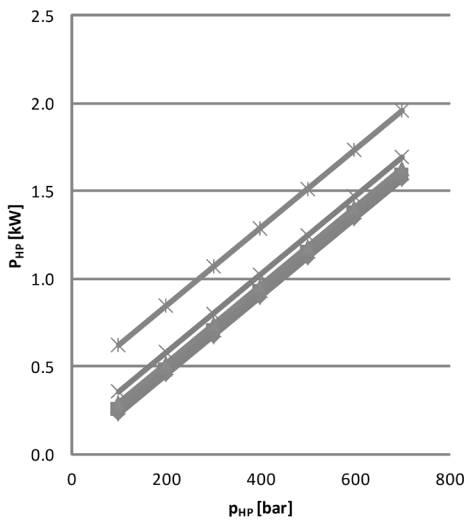
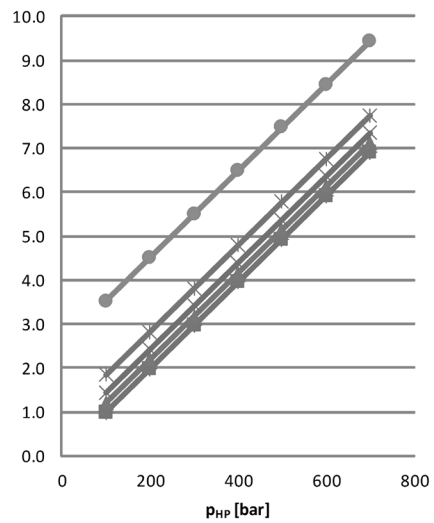
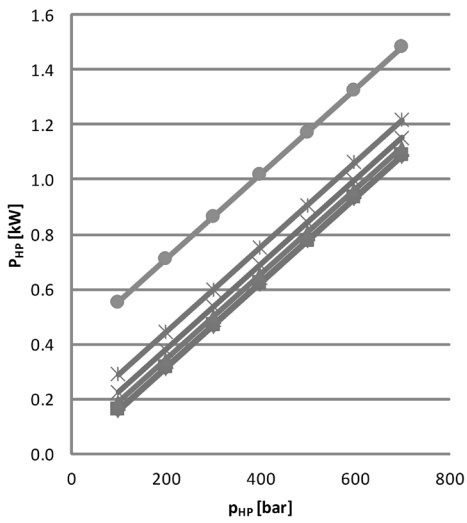

Type KKP

LP: 160 bar/0,35 to 4,60 cm³/rev
 HP: 700 bar/0,12 to 1,88 cm³/rev

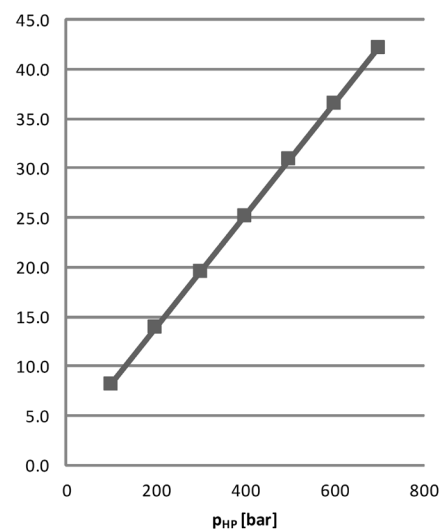
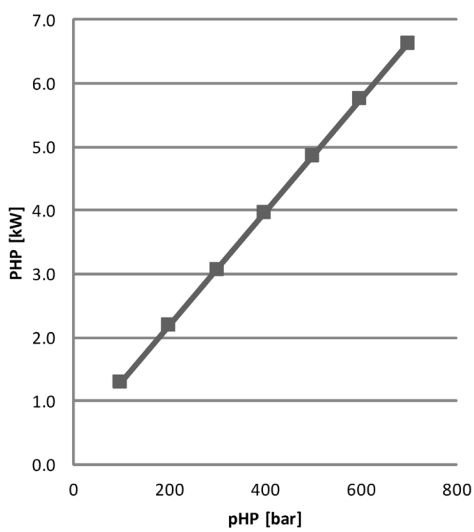
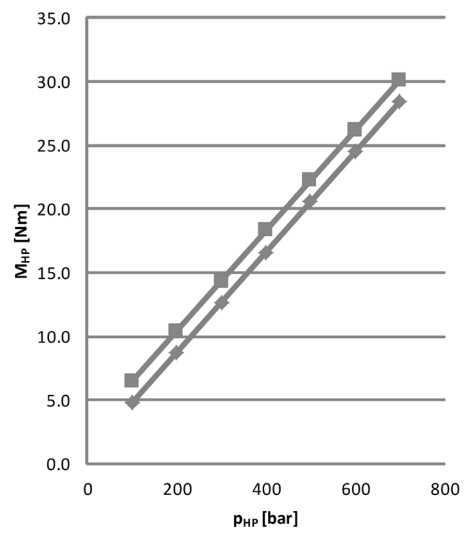
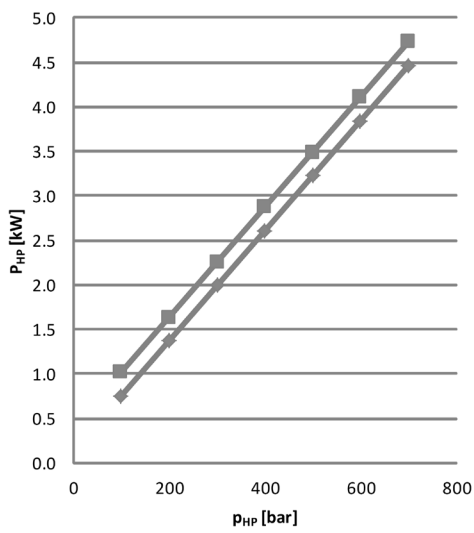
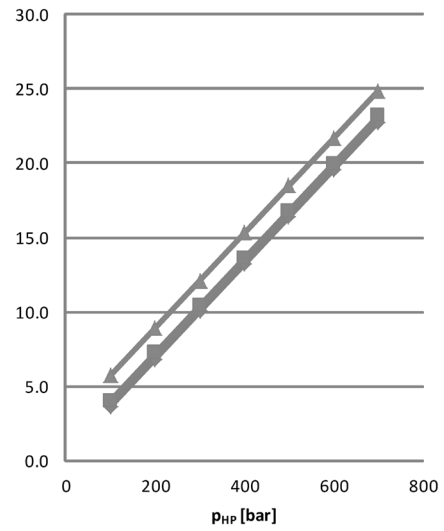
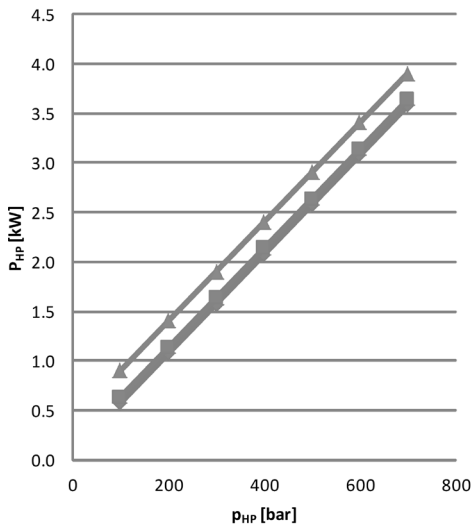

Type KKP

LP: 160 bar/0,35 to 4,60 cm³/rev
 HP: 700 bar/0,12 to 1,88 cm³/rev

Hydraulic schematic

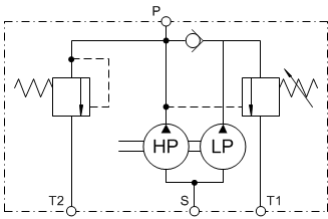

Dimensional drawings

Size **KKP01** / Design revision A

special motor size 71 2)
 with B5 flange
 dimensions of size 63

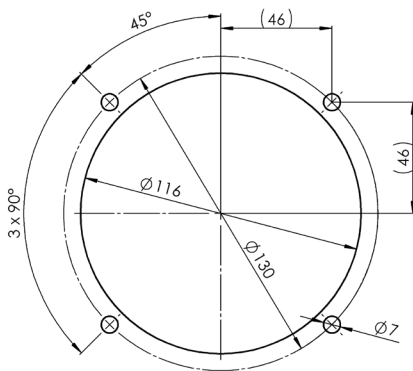
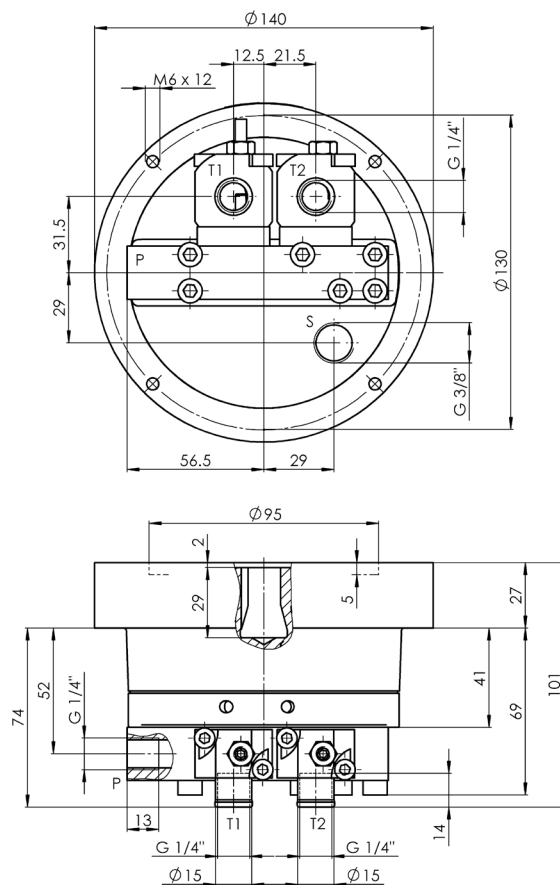
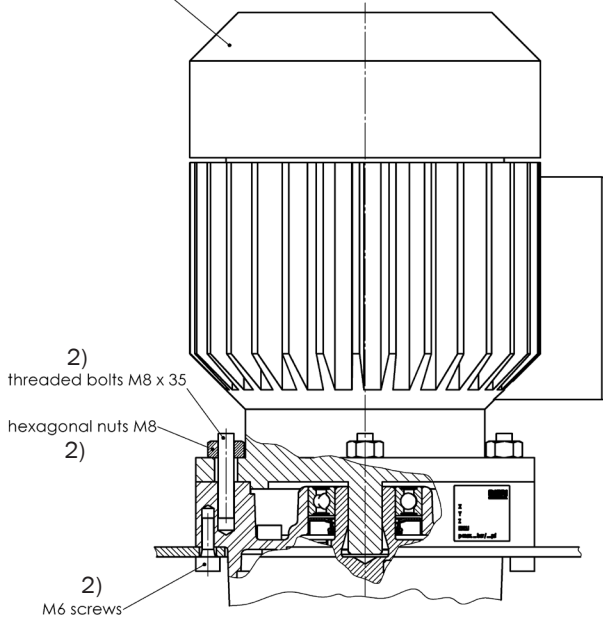

tank lid bore pattern

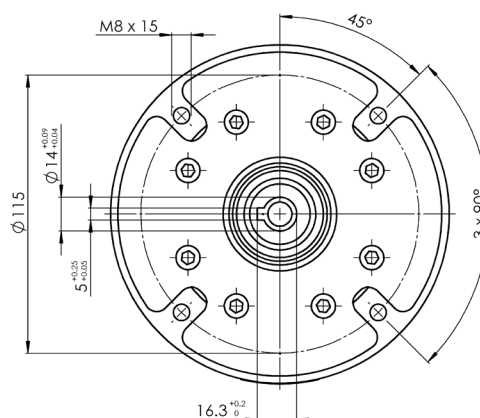

2) Not included in the scope of supplier

Size KKP02 / Design revision A

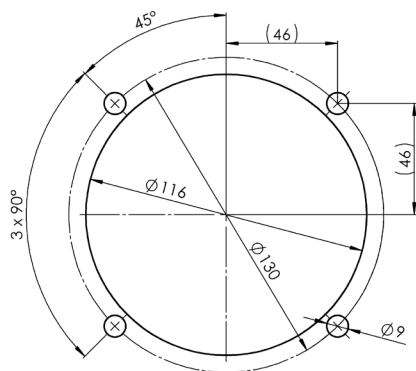
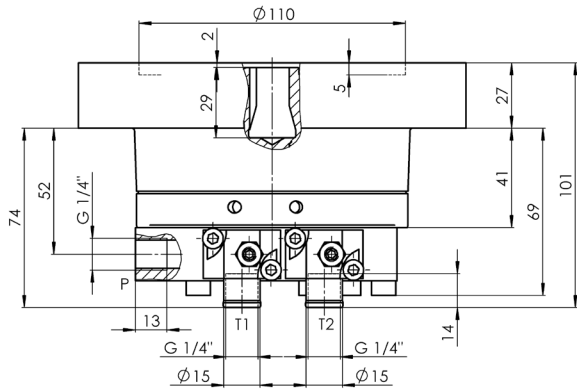
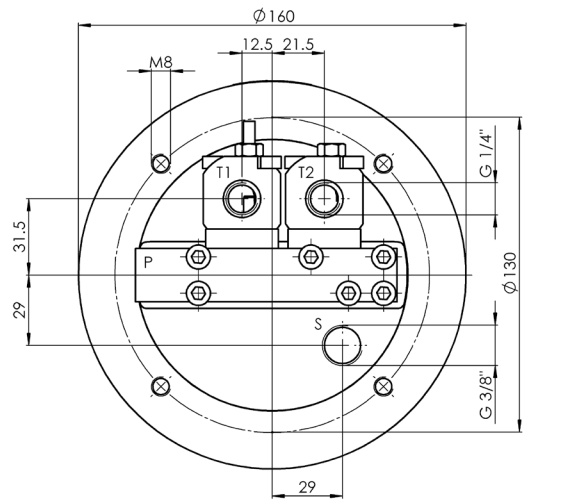
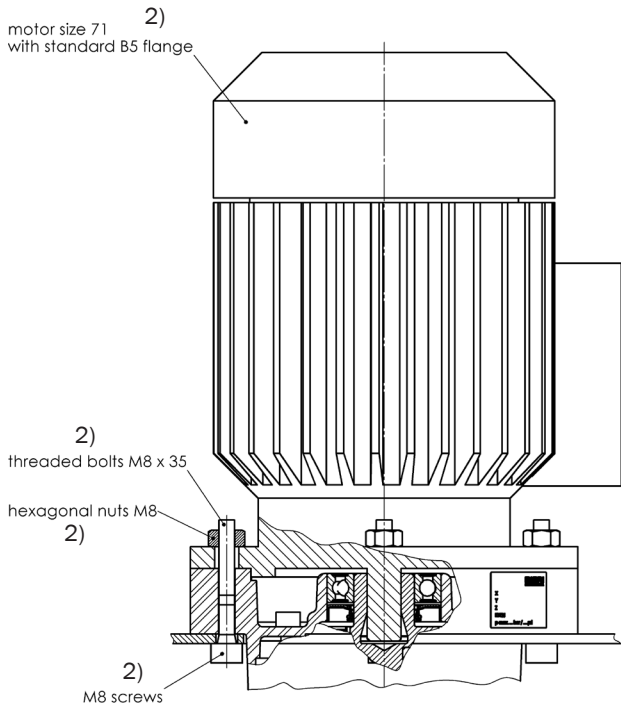

tank lid bore pattern

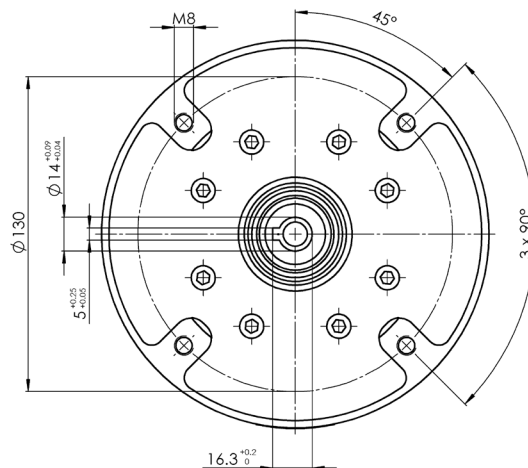

2) Not included in the scope of supplier

Type KKP

LP: 160 bar/0,35 to 4,60 cm³/rev
 HP: 700 bar/0,12 to 1,88 cm³/rev

Size KKP03 / Design revision B

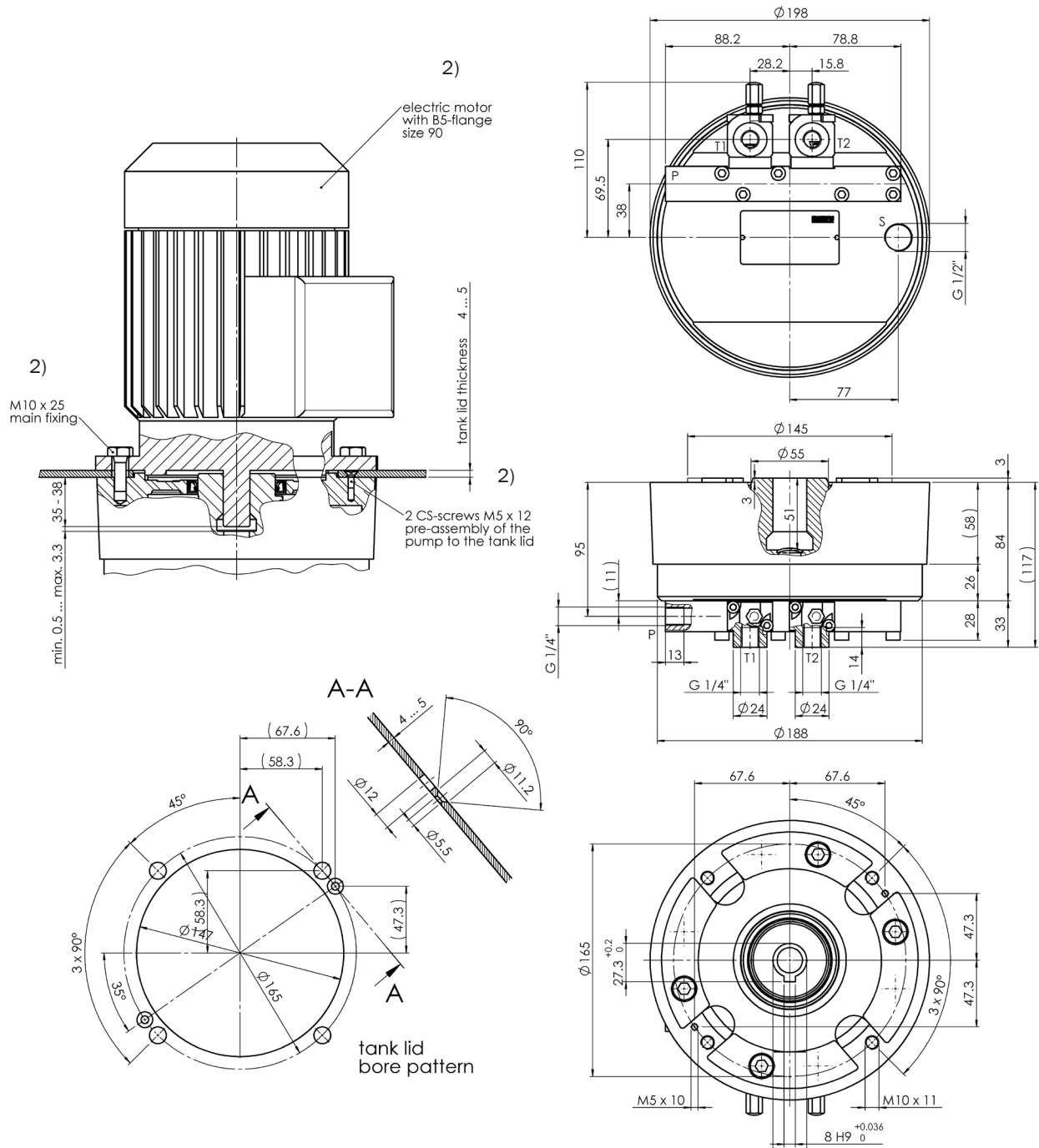

2) Not included in the scope of supplier

Type KKP

LP: 160 bar/0,35 to 4,60 cm³/rev
 HP: 700 bar/0,12 to 1,88 cm³/rev

Size KKP04 / Design revision B

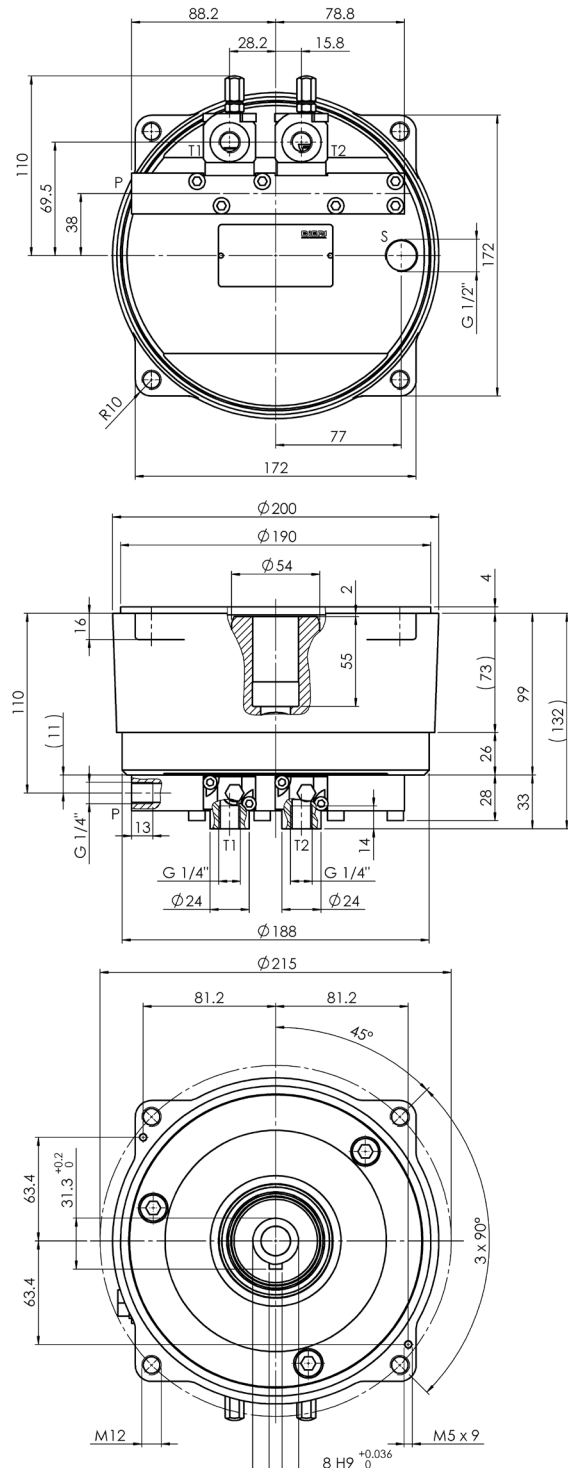
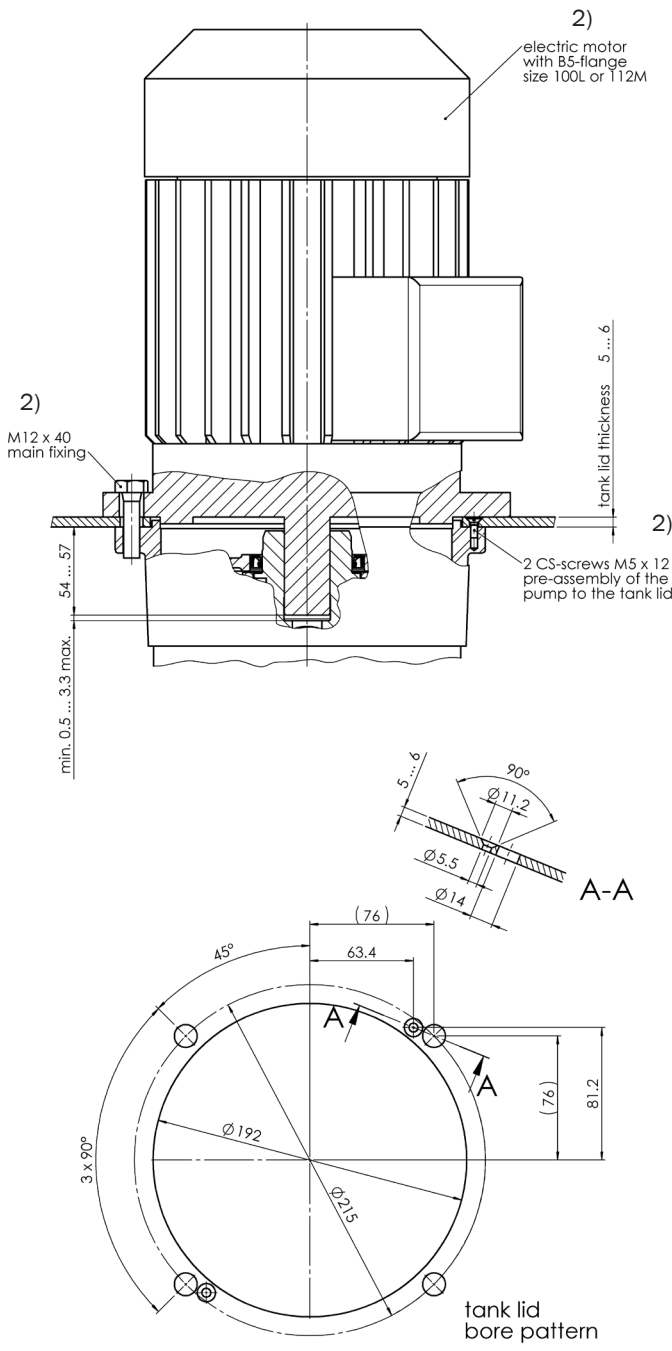

2) Not included in the scope of supplier

Type KKP

LP: 160 bar/0,35 to 4,60 cm³/rev
 HP: 700 bar/0,12 to 1,88 cm³/rev

Size KKP05 / Design revision B

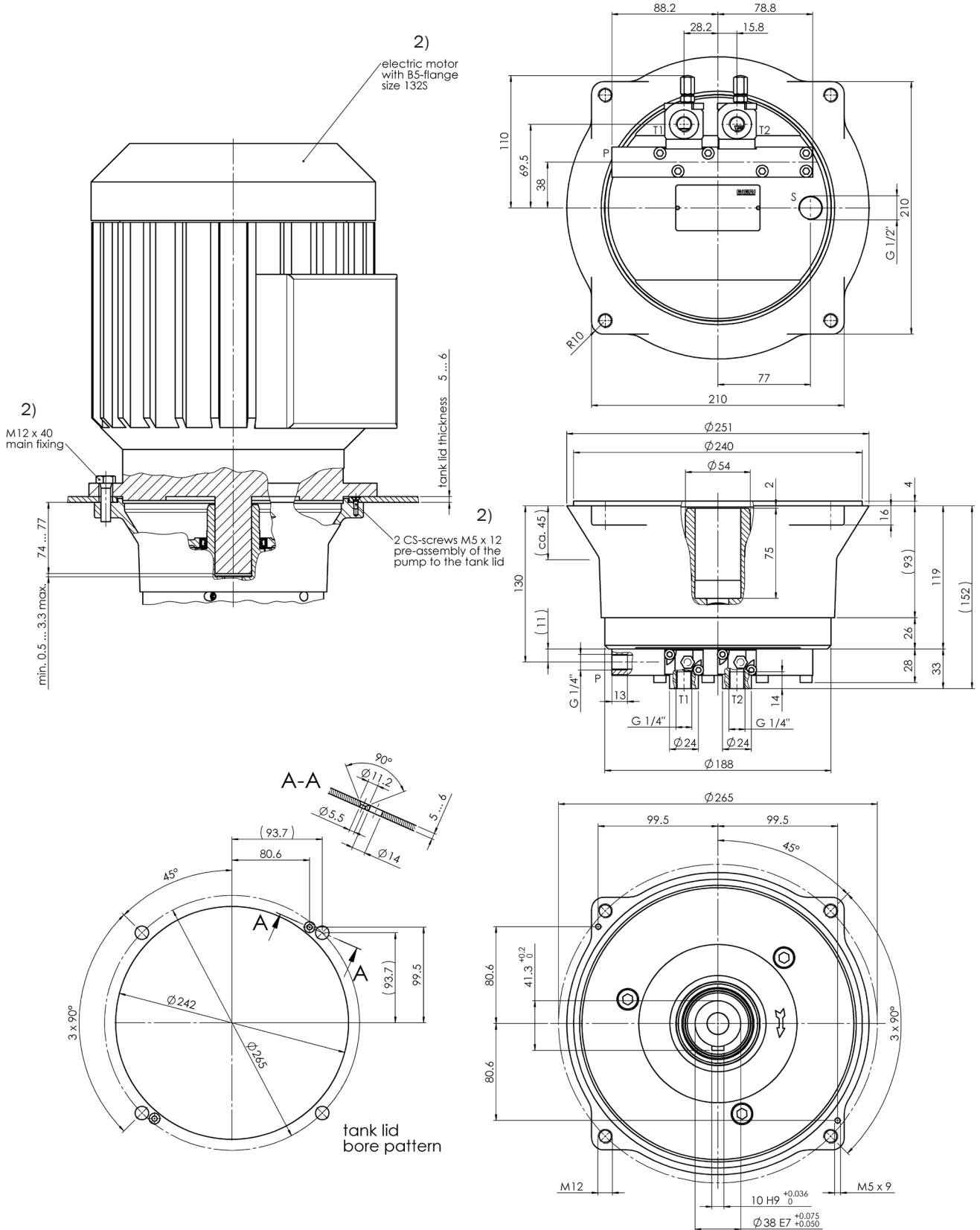

2) Not included in the scope of supplier

Functional schematic/diagram

Functional schematic

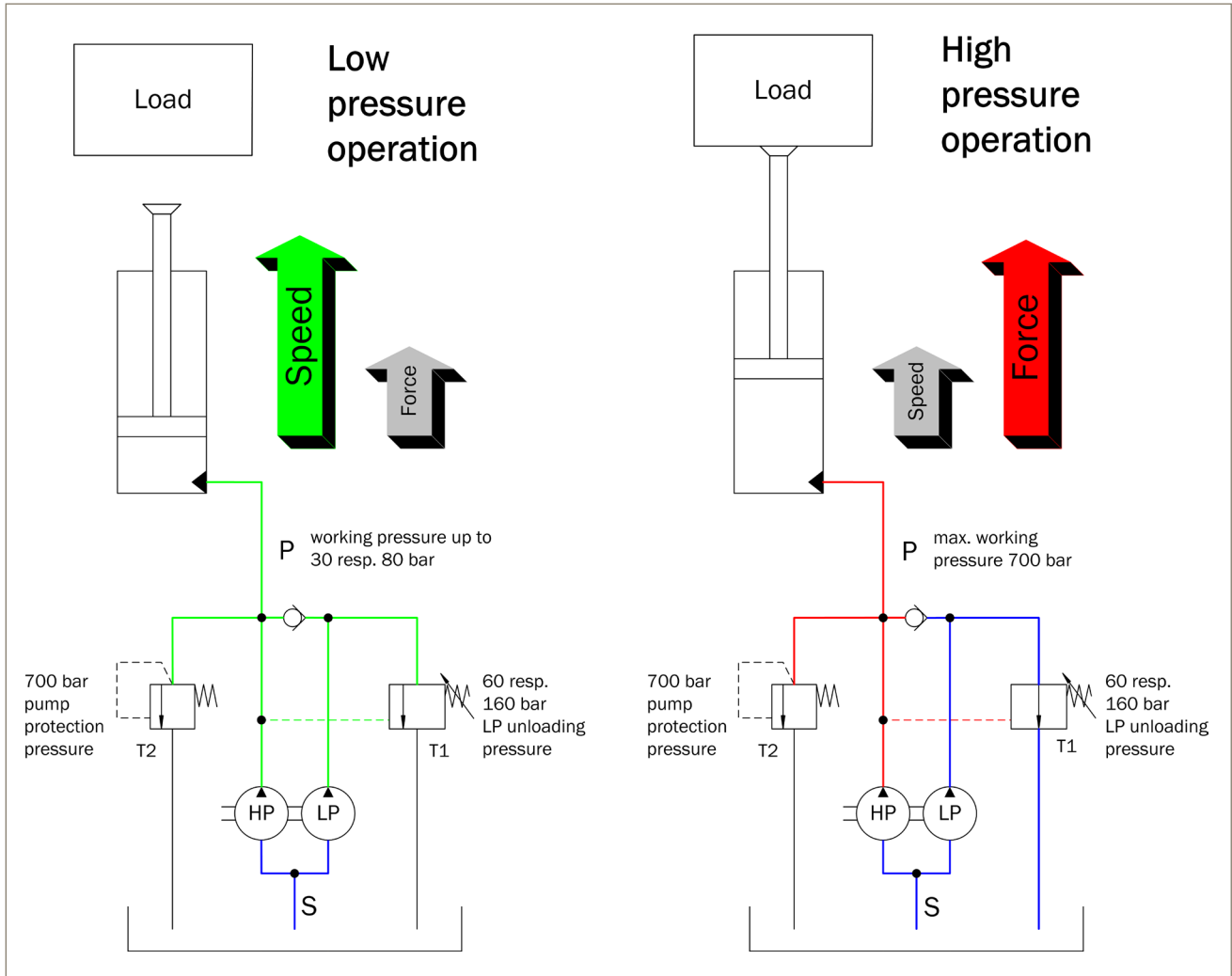

Type KKP

LP: 160 bar/0,35 to 4,60 cm³/rev
HP: 700 bar/0,12 to 1,88 cm³/rev

Functional diagram size KKP01 and 02

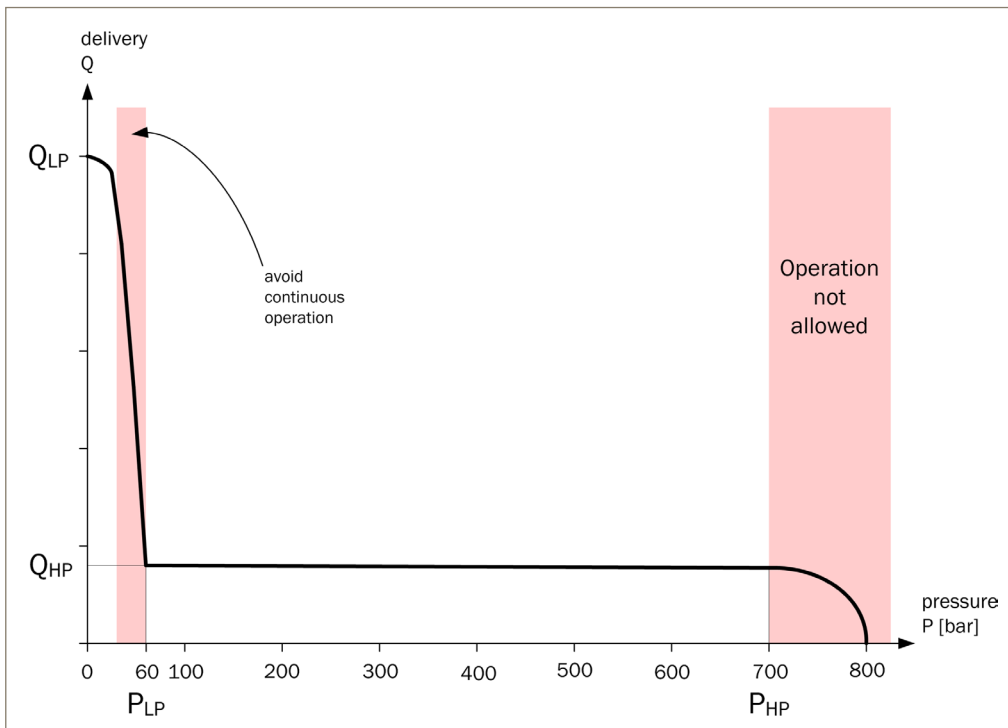

Functional diagram size KKP03, 04 and 05

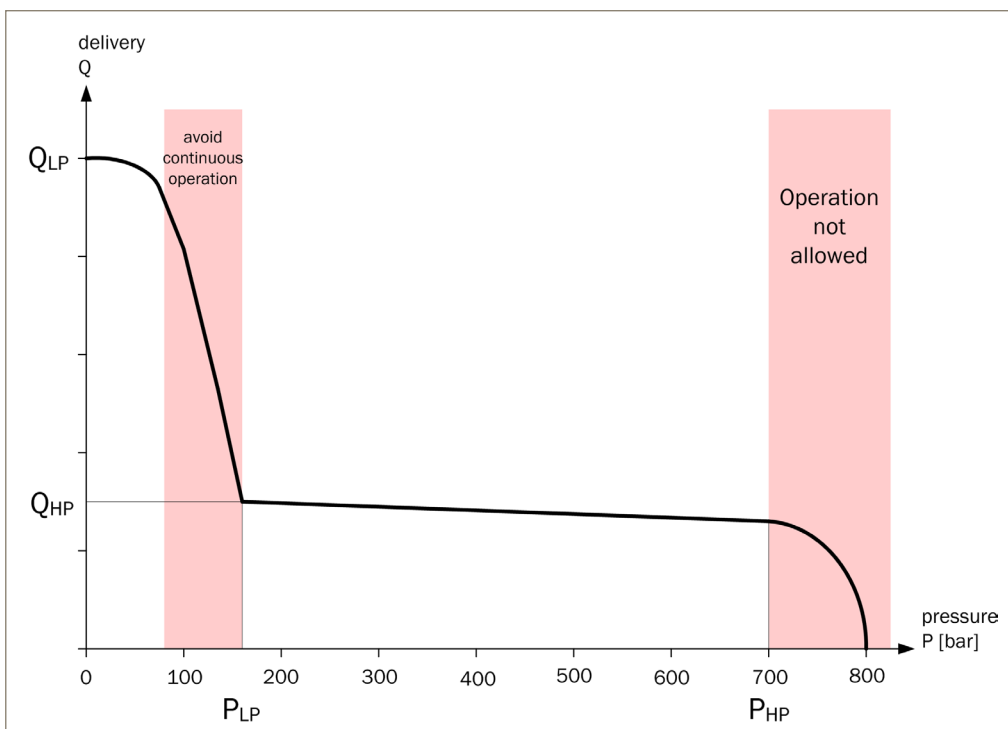

Bieri Hydraulik AG

Könizstrasse 274
CH-3097 Liebefeld
Tel. +41 31 970 09 09 | Fax +41 31 970 09 10
info@bierihydraulics.com | www.bierihydraulics.com

The information in this brochure relates to the operating conditions and applications described.
For applications and operating conditions not described, please contact the relevant technical department.
Subject to technical modifications.